

## SOT23-8

**Package Code: AE**

SOT23-8 (2.90mm x 2.80mm x 1.20mm)

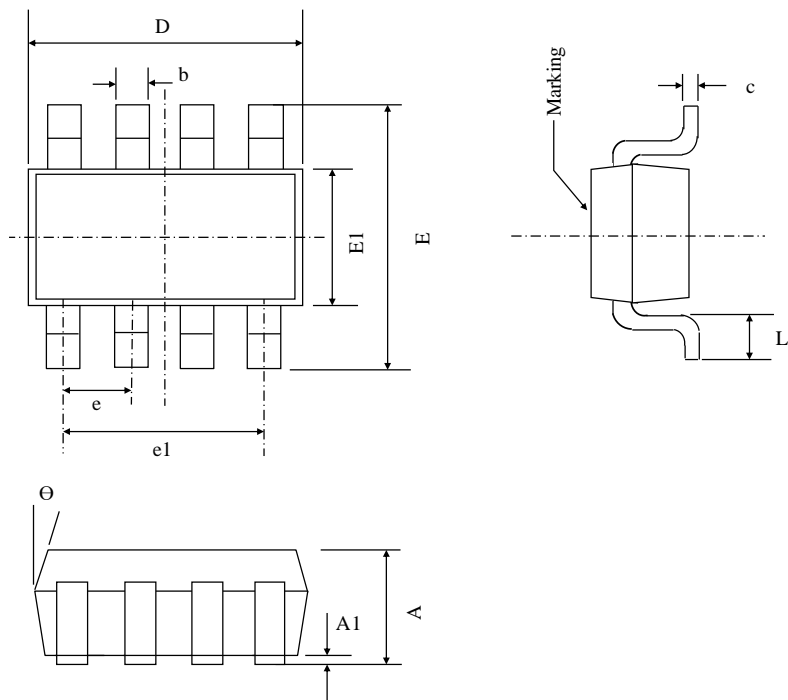

Dimension	mm		
	Min.	Typ.	Max.
A	0.95	1.20	1.45
A1	0.00		0.15
b	0.30	0.40	0.50
c	0.08	0.15	0.22
D	2.70	2.90	3.10
E	2.60	2.80	3.00
E1	1.40	1.60	1.80
e		0.65BSC	
e1		1.95BSC	
L	0.30		0.60
$\theta$	5°		15°

Kinetic Technologies cannot assume responsibility for use of any circuitry other than circuitry entirely embodied in a Kinetic Technologies product. No intellectual property or circuit patent licenses are implied. Kinetic Technologies reserves the right to change the circuitry and specifications without notice at any time.